

Eracle

STORAGE UNITS

2016

Antonio Citterio



Description

The Eracle storage unit for the sleeping area features rigorous, well-balanced proportions. Also proposed in a double-sided version, it is characterised by volumes, doors and backs with transparent glass (lined internally with high-tech fabric) and metallic profiles. The use of precious materials ensures minimal, sophisticated aesthetics: the wooden frame comes in all the essences available in the catalogue, while the interior is lined with melamine faced colonial leather and is fitted with a chest of drawers. Trays and clothes rails in colonial leather and a complete range of accessories offer extensive customisation solutions. The light positioned inside the storage unit offers a refined vintage detail that echoes the display units of the 1950s.

Technical information

External frame
veneered wood particles panel
Internal frame, shelf, drawer and tray bottom base
leather melamine faced wood fibre panels
Chest of drawers frame
wood particles panels
Chest of drawers upper top and clothes rail
covered in leather
Hinged door
coupled glass with metal high-tech fabric
Door profile, handle, multipurpose shoes rack, drawer frame and extractable tray
aluminium profiles
LED lamp
version EU (CEE) 220-240V 50Hz
version U.K. (UK) 220-240V 50Hz
version U.S.A. (UL) 110-120V 50Hz

Technical drawings

ARC1_M

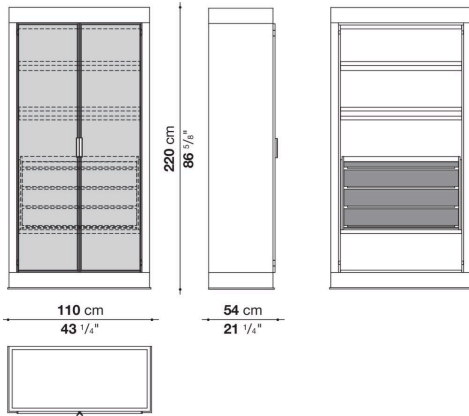

ARC2_M

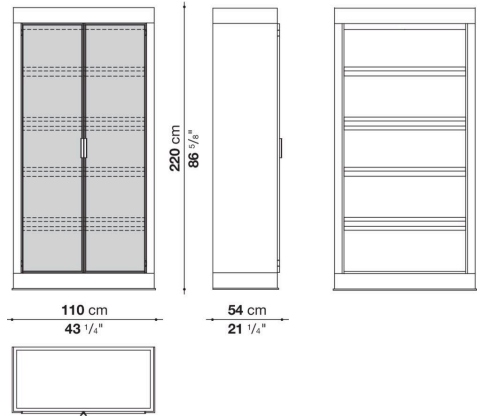

ARC5_M

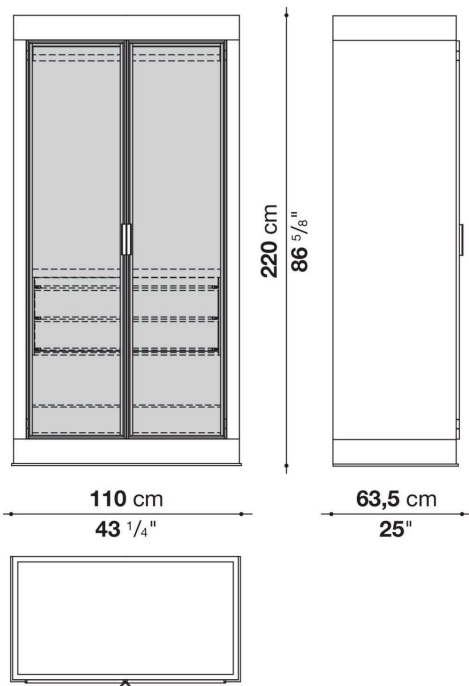

ARC6_M

