



Matisse International Furniture

99 The Strand
Parnell
Auckland 1010

E-Mail: melanie.williams@matisse.co.nz
Website: www.matisse.co.nz

Model: AK_05

Contact Information:
Our ref.:

Alan Office



Matisse International Furniture

99 The Strand
Parnell
Auckland 1010

E-Mail: melanie.williams@matisse.co.nz
Website: www.matisse.co.nz

Model: AK_05

Contact Information:
Our ref.:

Alan Office

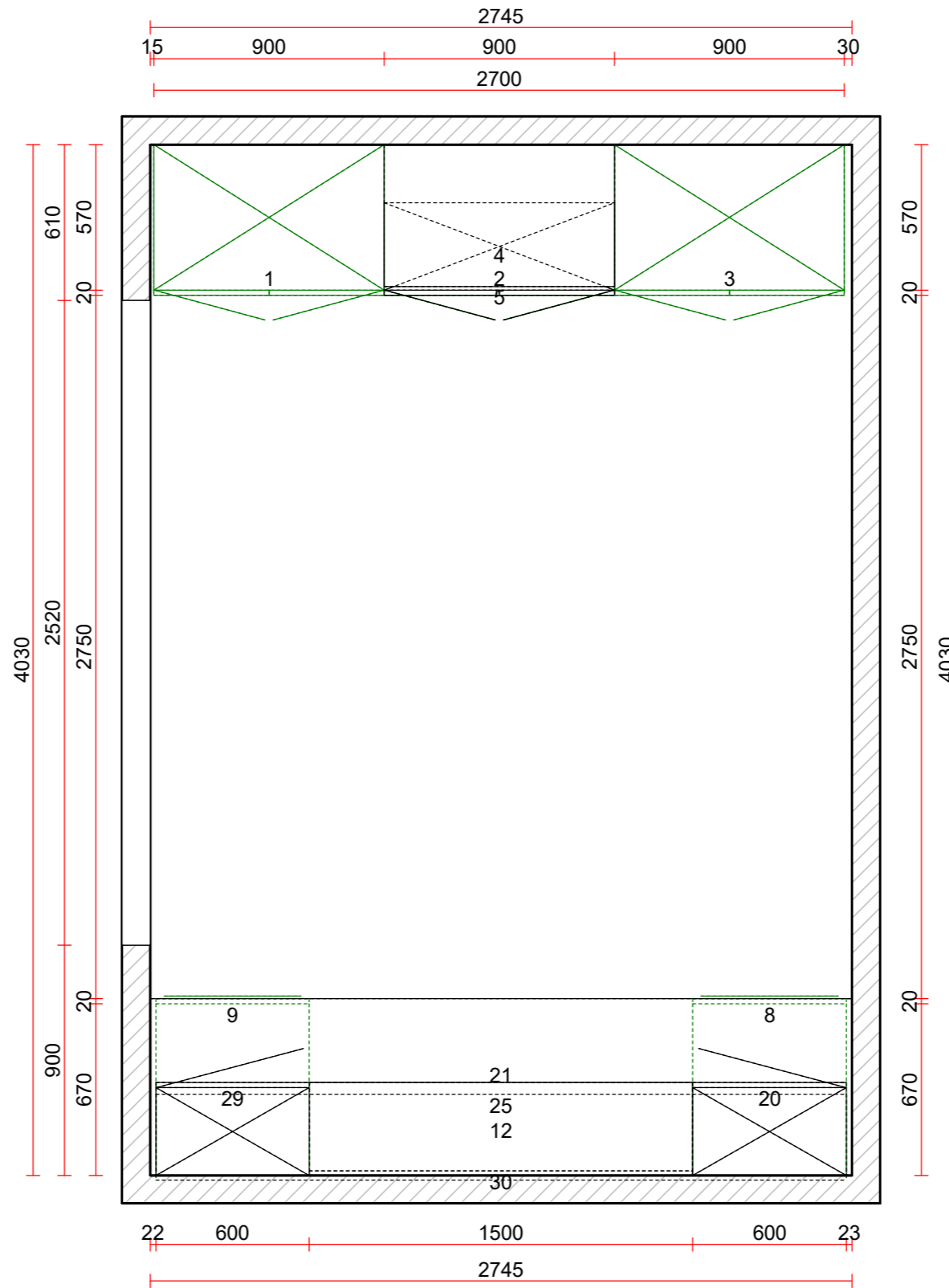

Scale : Fit to frame



Matisse International Furniture
 99 The Strand
 Parnell
 Auckland 1010

E-Mail: melanie.williams@matisse.co.nz
 Website: www.matisse.co.nz

Model: AK_05

Contact Information:
 Our ref.:

Alan Office

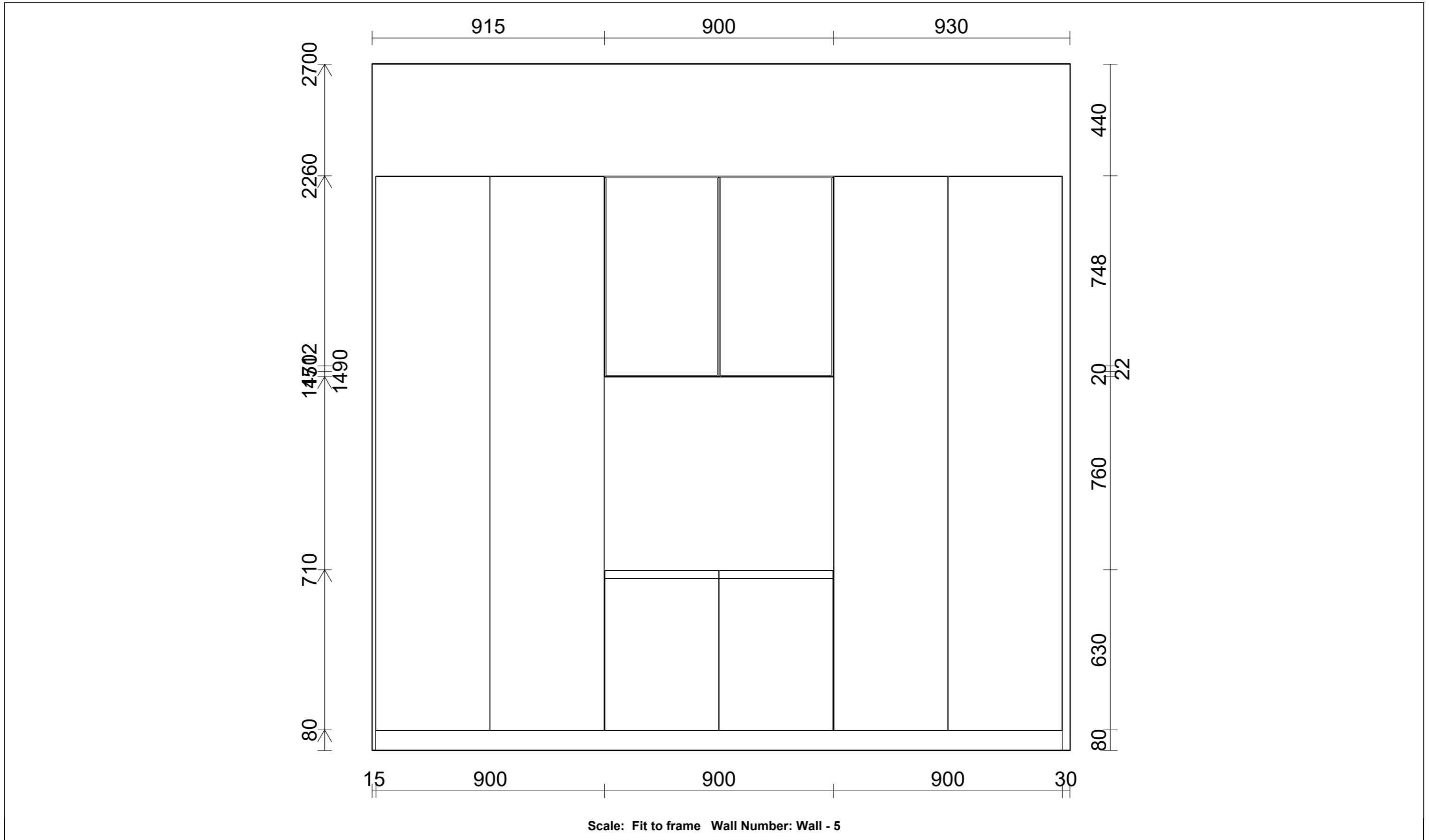

Matisse International Furniture
 99 The Strand
 Parnell
 Auckland 1010

E-Mail: melanie.williams@matisse.co.nz
 Website: www.matisse.co.nz

Model: AK_05

Contact Information:
 Our ref.:

Alan Office

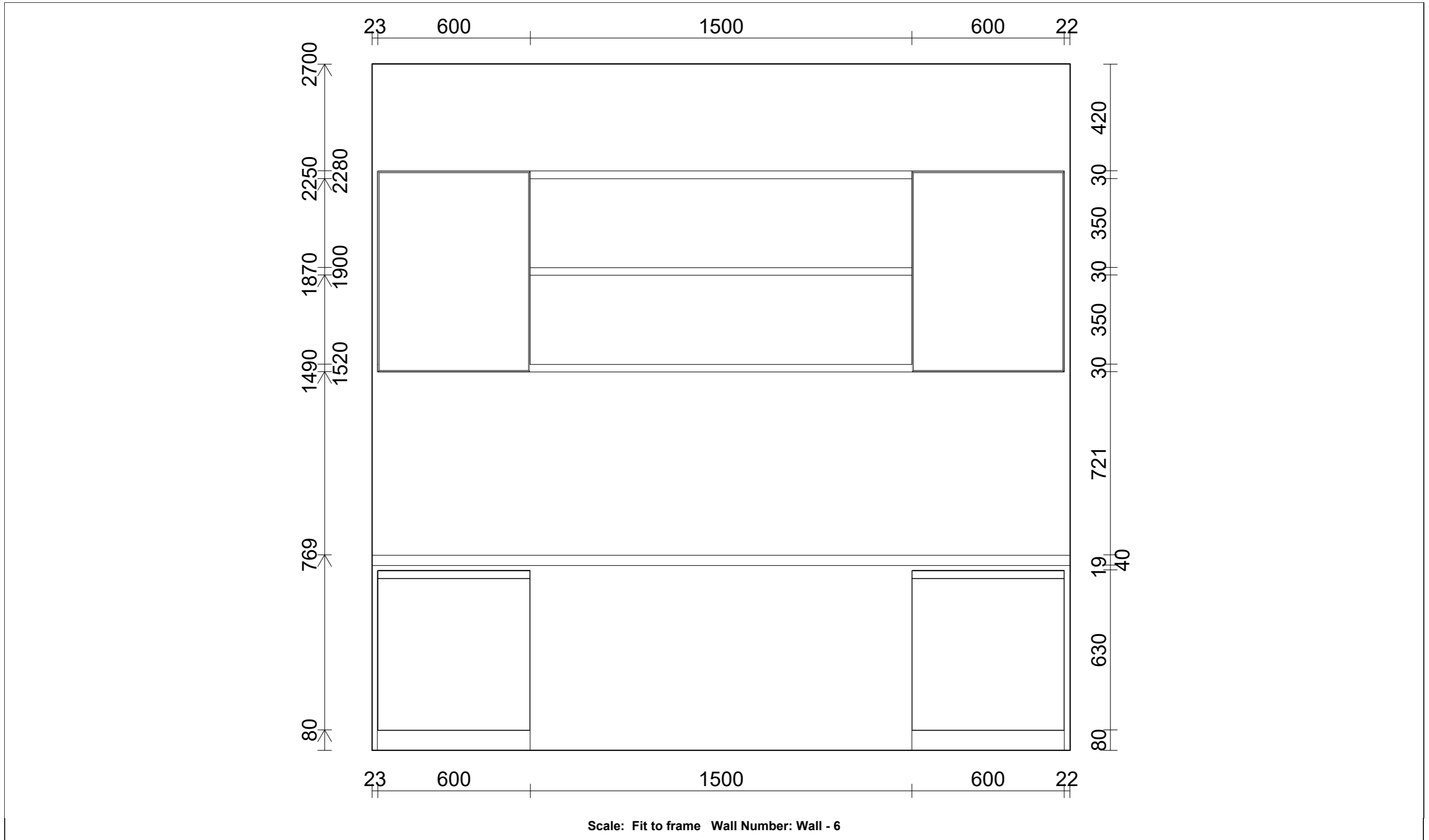

Matisse International Furniture
 99 The Strand
 Parnell
 Auckland 1010

E-Mail: melanie.williams@matisse.co.nz
 Website: www.matisse.co.nz

Model: AK_05

Contact Information:
 Our ref.:

Alan Office

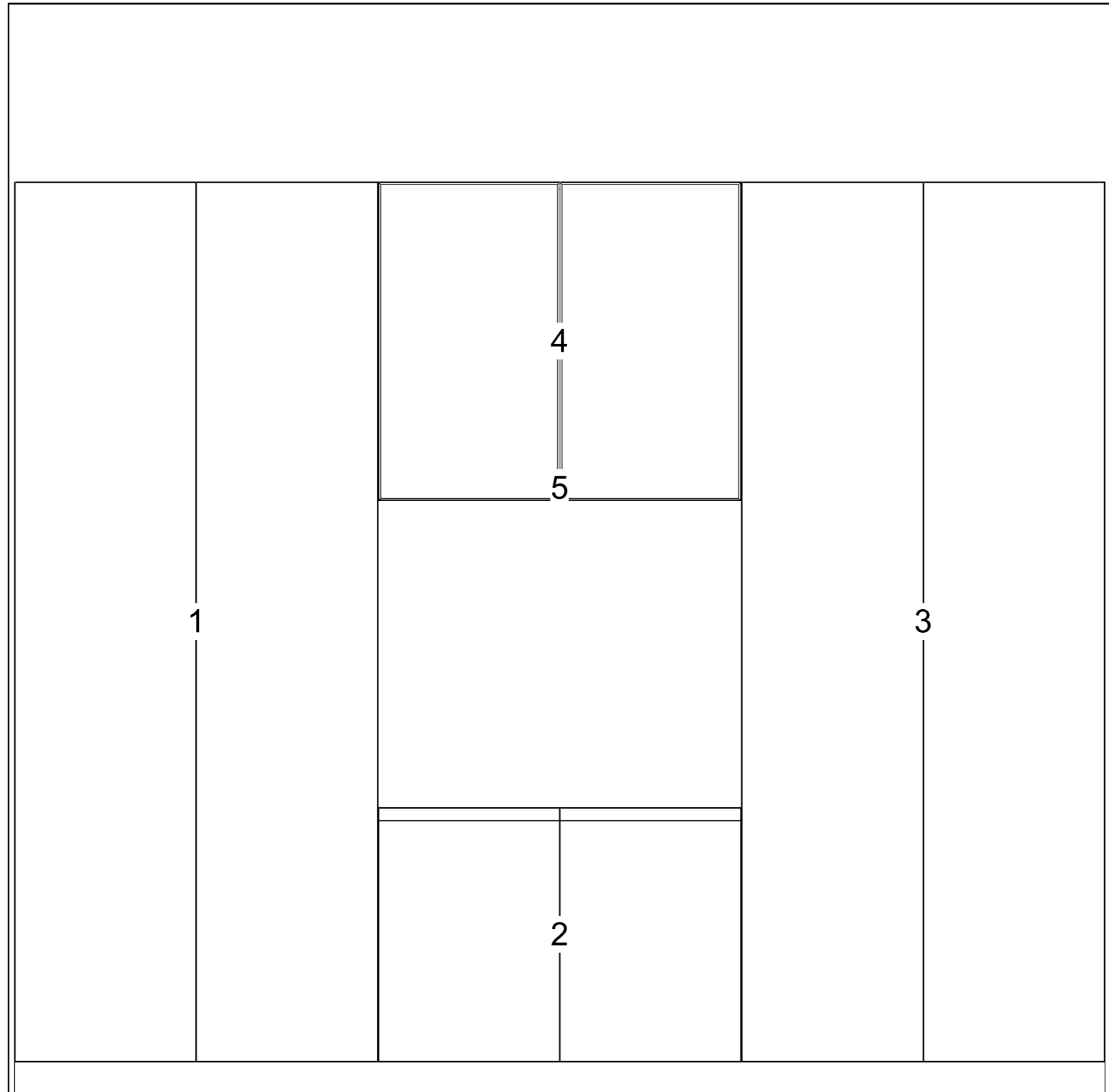

Scale: Fit to frame Wall Number: Wall - 5

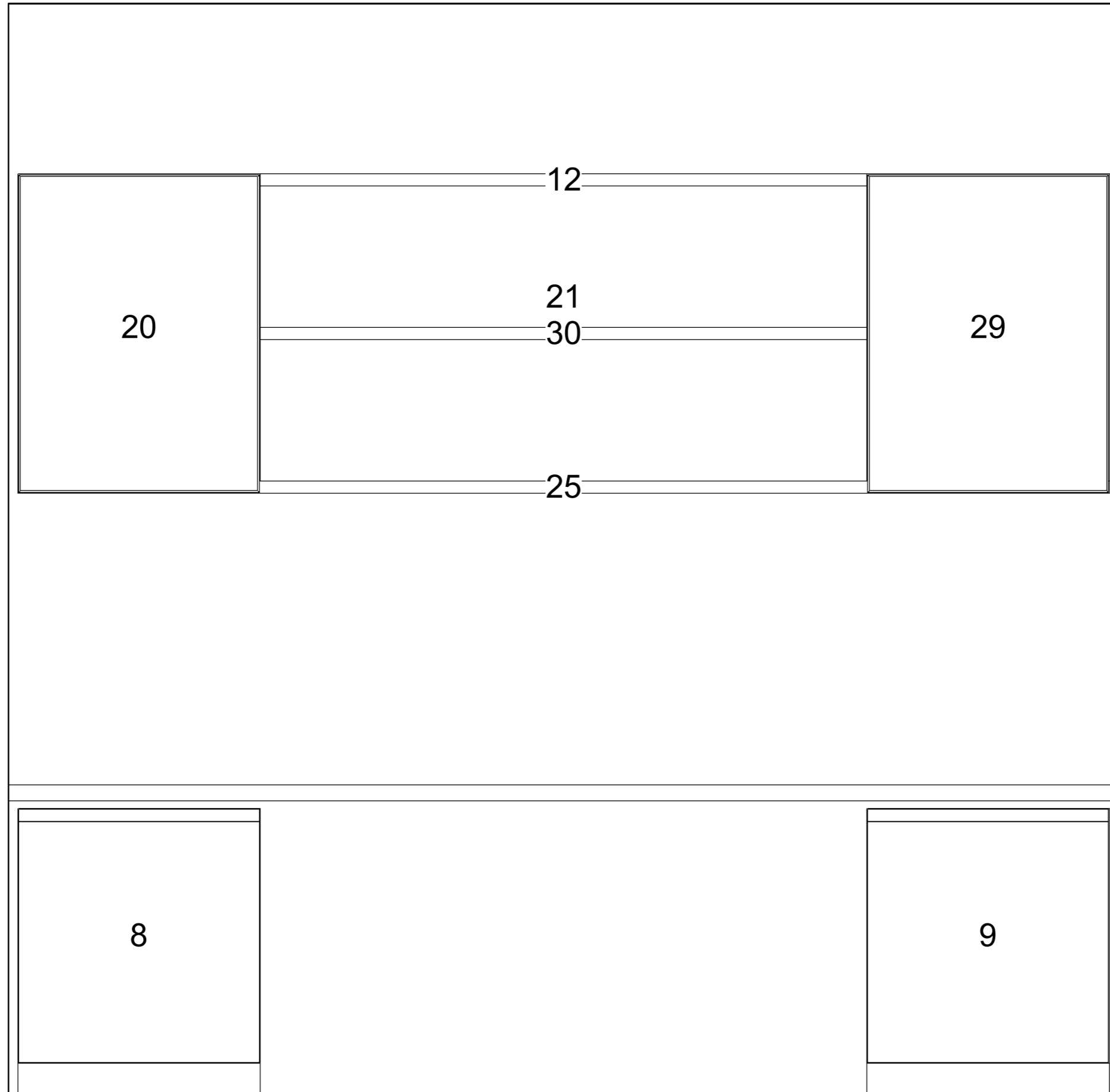

Scale: Fit to frame Wall Number: Wall - 6

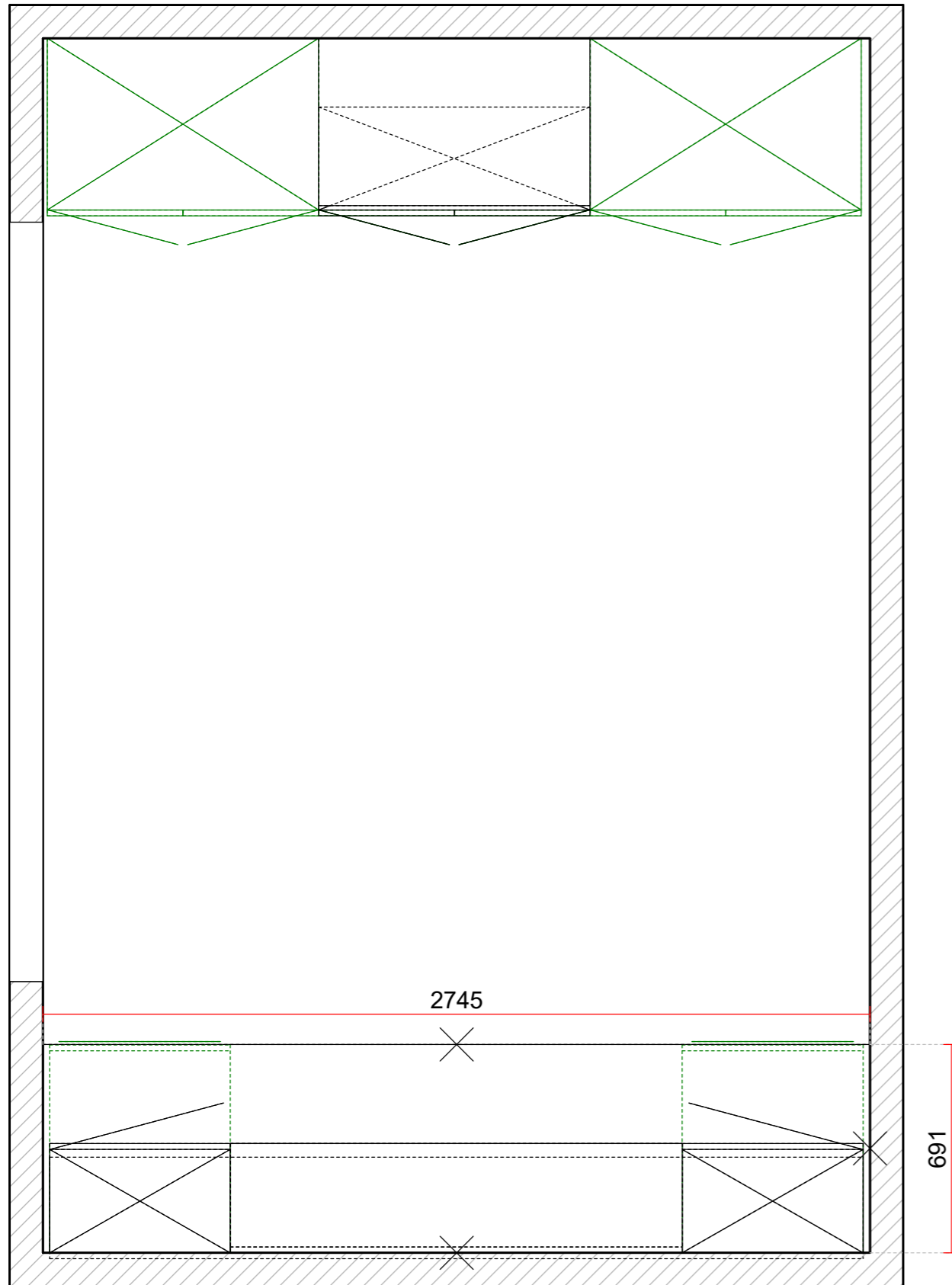

Scale: Fit to frame

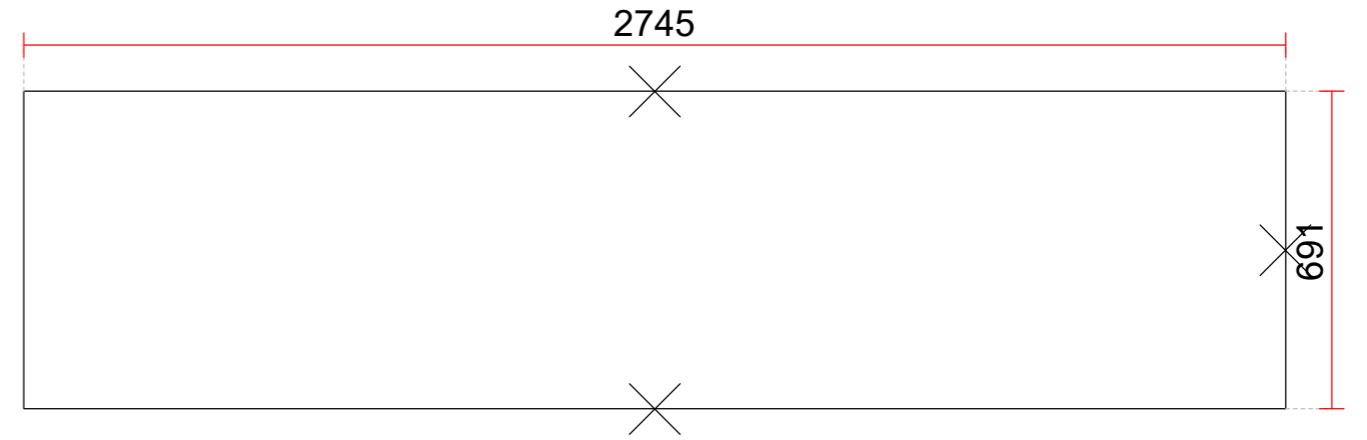

Matisse International Furniture

99 The Strand
Parnell
Auckland 1010

E-Mail: melanie.williams@matisse.co.nz
Website: www.matisse.co.nz

Model: AK_05

Contact Information:
Our ref.:

Alan Office



Quotation No: 142/1/2
Alternative: Alternative - 2
Quotation date:
Valid until:
Our ref.

Matisse International Furniture
Registration Number: 45-891-819
99 The Strand Parnell
Auckland 1010
Phone
melanie.williams@matisse.co.nz
www.matisse.co.nz

Customer

Alan Office

Phone

ELEMENT LIST

ARRITAL

Model Modern	: AK_05
Modular	: Base Unit With Groove H. 82
Edge Type	: 30° Edge Door 30°
Version	: Micromalta
Door Finish	: MC32 Micromalta
Gola Type	: Gola Flat
Gola Finish	: Standard
Groove Colour	: Burnished
Shell	: Graphite
Drawer/Pan Drawer Finishes	: Black
Plinth	: Aluminium
Plinth Finish	: Anodised
Plinth Colour	: A Burnished
Panels And Shelves	: Brushed Oak
Panels And Shelves Finish	: Contacts
Rear Panels	: Micromalta
Rear Panel Finish	: MC32 Micromalta

Furniture

Pos	Code	Description	Hinge	Qty
1	NCX6A290	Tall unit 90, 2 doors		1.00
2	NG66A290	Base unit 90, 2 doors		1.00
3	NCX6A290	Tall unit 90, 2 doors		1.00
4	NPP3A290	Wall unit 90, 2 doors		1.00
5	TFNU22602	2.2 cm thick panel, d. 37.3-60 cm Width = 900, Depth = 555, Edge type = Off, Height = 22		0.02
8	NG68E360	Base unit 60, 1 pull-out pan drawer, 1 internal drawer		1.00
9	NG68E360	Base unit 60, 1 pull-out pan drawer, 1 internal drawer		1.00
20	NPP3A160	Wall unit 60, 1 door Height = 760, Rebuilt front	L	1.00
20.1	SPZ0001	Increase for reduction of furniture in height (+30%)		1.00
21.1	TM02006	t' shape shelf bracket (for shelf bracket with retractable supports)		12.00
29	NPP3A160	Wall unit 60, 1 door Height = 760, Rebuilt front	R	1.00
29.1	SPZ0001	Increase for reduction of furniture in height (+30%)		1.00
501	TZAL00080	Plinth h. 8 cm in aluminium		7.79

Furniture(2)

Pos	Code	Description	Hinge	Qty
12	TMNT06373	Shelf brushed/flamed oak 3 cm thick, d. 15-37.2 cm Depth = 362, Width = 1500, Height = 30		1.50
21	TMNT06373	Shelf brushed/flamed oak 3 cm thick, d. 15-37.2 cm Depth = 344, Width = 1500, Height = 30		1.50
25	TMNT06373	Shelf brushed/flamed oak 3 cm thick, d. 15-37.2 cm Depth = 337, Width = 2700, Height = 30		2.70
30	TTES01181	Panel 1.8 cm, brushed/flamed oak Width = 1500, Height = 790 <i>Brushed Oak</i> <i>Panels And Shelves Finish Bark</i>		1.19